

# PANIC EXIT DEVICES

**NO PANIC, NO BACTERIA, NO ADDITIONAL COST.**

**Anti**  
GERM



AntiGerm is an absolutely safe permanent antibacterial treatment which ISEO has decided to use on its range of Panic Exit Devices.

It is based on the slow and constant release of silver ions which penetrate the microbial organism and prevent its reproduction by attacking its DNA and finally inhibiting cellular respiration.

## 4.1 MILLION INFECTIONS IN EUROPEAN HOSPITALS

Infections in hospitals are often underestimated both from a medical and cultural point of view. Every year in Europe 4.1 million patients acquire an infection in hospitals.\*

\* Source: Sanità in Cifre, 23/02/2012

## 650+ BACTERIAL SPECIES

In a few minutes AntiGerm kills more than 650 viruses, molds, alga, mycosis and bacteria species (such as Legionella, Salmonella and MRSA) thanks to a continuous action 24 hours a day, 7 days a week  
reducing bacteria levels by 99%



ANTIGERM CERTIFICATION



## INDEX TO RANGES

presented by



m.marcus  
est. 1940

**ISEO** has an ability to integrate Italian high design and technical innovation into a range of emergency exit devices that are setting new standards in both design and performance.

ISEO offers, without compromise, a wide range of emergency exit hardware devices together with a choice of superior finishes to compliment the appearance of any project.

ISEO emergency exit devices endure rigorous testing to achieve the performance and fire resistance requirements of either BS EN1125 or BS EN 179 emergency exit devices as applicable.

ISEO emergency exit devices can be installed to most door material types by adding the relevant additional components found within the accessories section of this catalogue.

**Page:**

**38 - 43**

**44 - 47**

**48 - 51**

**52 - 55**

**56 - 59**

**60 - 61**

**62 - 66**

**67 - 74**

Applicable  
where you see  
these symbols



Guild of  
Architectural Ironmongers

ENVIRONMENTAL MANAGEMENT



Certificate No. FM 35735  
ISO 9001:2008

QUALITY MANAGEMENT



Certificate No. EMS 572656  
ISO 14001:2004



**UK RANGE**



**PULLMAN RANGE**



**TOUCH RANGE**



**INOX RANGE**



**TRIM ACCESS DEVICES**



**PUSH SIRENA**



**PANIC HARDWARE ACCESSORIES**



**BELVEDERE FOR GLASS DOORS**



For use on  
fire doors



For use on  
escape doors



**CERTIFICATE OF APPROVAL**  
**NO CF 5233**



# OUR STANDARDS.

## THE NEW 2008 EN179:2008 STANDARDS FOR PANIC EXIT & EMERGENCY DEVICES

The new standards do not oblige ISEO to introduce any further changes to its products, as they are already designed in total compliance with the new regulations which have been effective since January 1, 2009.

Dealers will be allowed to sell the products marked according to the old standards until stock exhaustion, without time limits.

ISEO dealers know they are selling products which fully complied with the standards before January 1, 2009, and for which only the mark has been changed.

The new certificates also show compliance of products with the previous mark.



Our products have also obtained the ICIM "P" voluntary certification which provides for further external testing to assert product quality.

### Warning

The field of application of these panic exit devices is limited to the following:

Maximum door mass	Maximum door height	Maximum door width	Temperature interval
200 Kg	2520 mm	1320 mm	-10°C+60°C

The limits indicated above are identified by EN1125 standard. ISEO Serrature declares that the performances of the devices and their accessories are in compliance with the requirements of the standard, for doors with mass max. 200 kg, height max. 3400 mm and width max. 1500 mm.

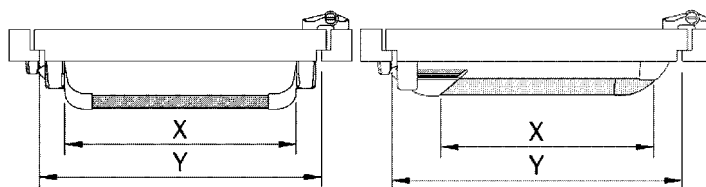

Fig. 1

Fig. 1

The effective length (dimension X) of the bar shall be as near as possible to the effective width (dimension Y) of the door for which the device is intended, but never less than 60% (Fig.1)

The door leaves and frames must be made of a material with sufficient rigidity to ensure that any distortions that occur during use can not exceed 5 mm in any position. The device must be fitted to the door leaf using materials that guarantee a tensile strength for each screw of >1,5KN.

### Products certifications

Iseo Serrature has been awarded by Warrington Certification Limited (WCL) the certificate of conformity with EN 1125:08 standard allowing to apply the CE mark on panic exit devices, compulsory from 01/04/2003.

ISEO panic exit devices have already obtained the Voluntary Product Certification by an independent organisation, ICIM, as provided for in EN 1125:08.

The ICIM voluntary certification establishes stricter requirements than the CE mark.

All the updated certificates can be downloaded from our web site: [www.m-marcus.com](http://www.m-marcus.com)



## How to read the marking **EN 1125:2008**

Not suitable for fire/smoke doors	3	7	6	0	1	4	2	2	A	A
Suitable for fire/smoke doors	3	7	6	B	1	4	2	2	A	A
	Category of use	Durability	Test door mass	Suitability for use on fire/smoke resistant doors	Safety	Corrosion resistance	Security	Projection of device	Type of bar operation	Field of application
	1	2	3	4	5	6	7	8	9	10



### Category of use.

There is only one category which refers to a high frequency of use where there is little incentive to exercise care, i. e. where there is a chance of an accident and misuse.

### Durability.

There are two grades of durability.  
grade 6 = 100,000 operations  
grade 7 = 200,000 operations

### Test door mass.

There are three door mass categories:  
grade 5 = up to 100 kg  
grade 6 = up to 200 kg  
grade 7 = over 200 kg

### Suitability for use on fire/smoke resistant doors.

Three fire/smoke resistance categories:  
grade 0 = not suitable for fire/smoke resistant doors  
grade A = suitable for smoke resistant doors  
grade B = suitable for fire/smoke resistant doors

### Safety.

There is only one category representing the maximum grade, since panic exit devices must ensure people's safety.

### Corrosion resistance.

There are two categories as per prEN1670:  
grade 3 = 96 h (high resistance)  
grade 4 = 240 h (very high resistance)

### Security.

Only one grade of security shall be used: the security requirements are secondary to those of safety.

### Projection of device.

There are two categories:  
grade 1 = bar projection up to mm 150 (large projection)  
grade 2 = bar projection up to mm 100 (standard projection)

### Type of bar operation.

There are two types of operations:  
A = panic exit device with "push-bar" operation  
B = panic exit device with "touch-bar" operation (Push-Bar)

### Field of application.

There are three categories:  
A = single door, double door: active or inactive leaf  
B = single door only  
C = double door, inactive leaf only

For further information please refer to  
**EN1125:97+ A1:2001 standard.**



## UK RANGE

### EMERGENCY EXIT DEVICE

## Features

- CE marked
- Simple to install
- Easily reversible
- High usage - tested to 200,000 cycles
- Aesthetically pleasing design
- Rounded edges for safe usage
- Suitable for most door types
- Outside access device to be ordered separately

## Classification

### EN 1125:2008

3	7	6	B	1	4	2	2	B	A
---	---	---	---	---	---	---	---	---	---

### EN 179:2008

3	7	6	A	1	4	4	2	A	B
---	---	---	---	---	---	---	---	---	---



For use on  
escape doors





LATERAL FIXING



## Push Pad Latch Emergency Exit Device

Ref: **IS946-1000705**

Finish: **Grey**

### UK RANGE

- For use on single doors
- Suitable for most door types in accordance with EN179:2008
- Operated by means of push pad

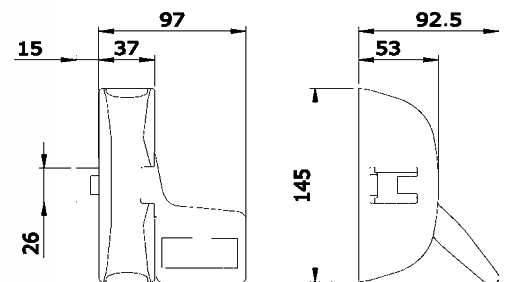

Standard  
**EN 179:2008**  
(see explanation opposite)





VERTICAL 2 POINT FIXING



## Push Pad Bolt Emergency Exit Device

Ref: **IS947-2020704**

Finish: **Grey**

- For use on single doors
- Suitable for most door types in accordance with EN179:2008
- Rods and Covers to a maximum door height of 2400mm
- Operated by means of push pad
- Non-rebated double doors

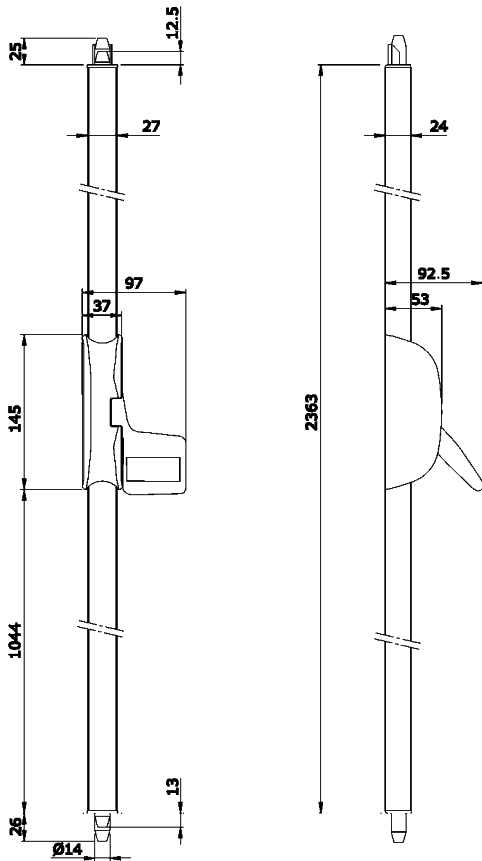

Standard

**EN 179:2008**

Emergency exit devices in compliance with standard EN 179 are conceived to be used where there is a very low probability for panic situations to happen, people are aware of the use of the emergency exit device and qualified for it. The aim of the standard requirements is mainly to ensure a reliable and safe evacuation through a door making use of the minimum effort, even though a prior knowledge of the door device might be necessary.





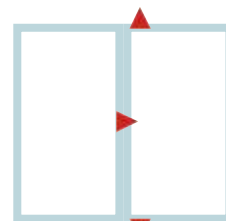

### LATERAL/VERTICAL FIXING

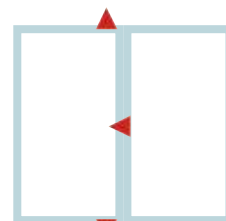

### LATERAL/VERTICAL FIXING

Finish: **Grey**

- For use on single doors, or as active leaf on double rebated door sets (See IS943-5083335 right)
- Bar supplied is 840 mm in width, For wider doors add bar IS945-923 (up to 1130 mm)
- Pre-set for manual hold open device
- Pre-set for micro switch
- EN-1125:2008

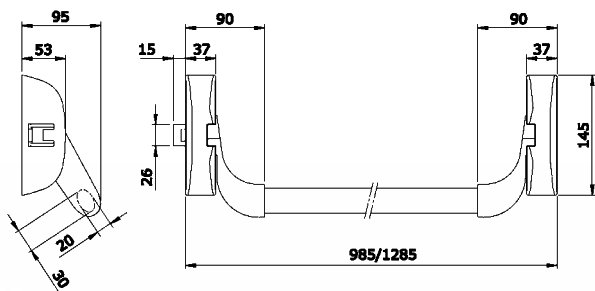

Finish: **Grey**

- For use on rebated door sets.
- For specifics refer to page 5
- EN-1125:2008





VERTICAL 2 POINT FIXING

## Vertical Panic Bolt Emergency Exit Device

Ref: **IS943-2083774**

Finish: **Grey**

- For use on single doors, or as passive leaf on double rebated door sets (See IS943-5083335 right)
- Bar supplied is 840mm in width, For wider doors add bar IS945-923 (up to 1130mm)
- Suitable for doors up to 2225mm high, for taller doors add rods and covers set, IS943-00303 (up to 3400mm)
- Anti - thrust
- 2 point locking for higher security
- Pre-set for manual hold open device
- Pre-set for micro switch
- EN-1125:2008

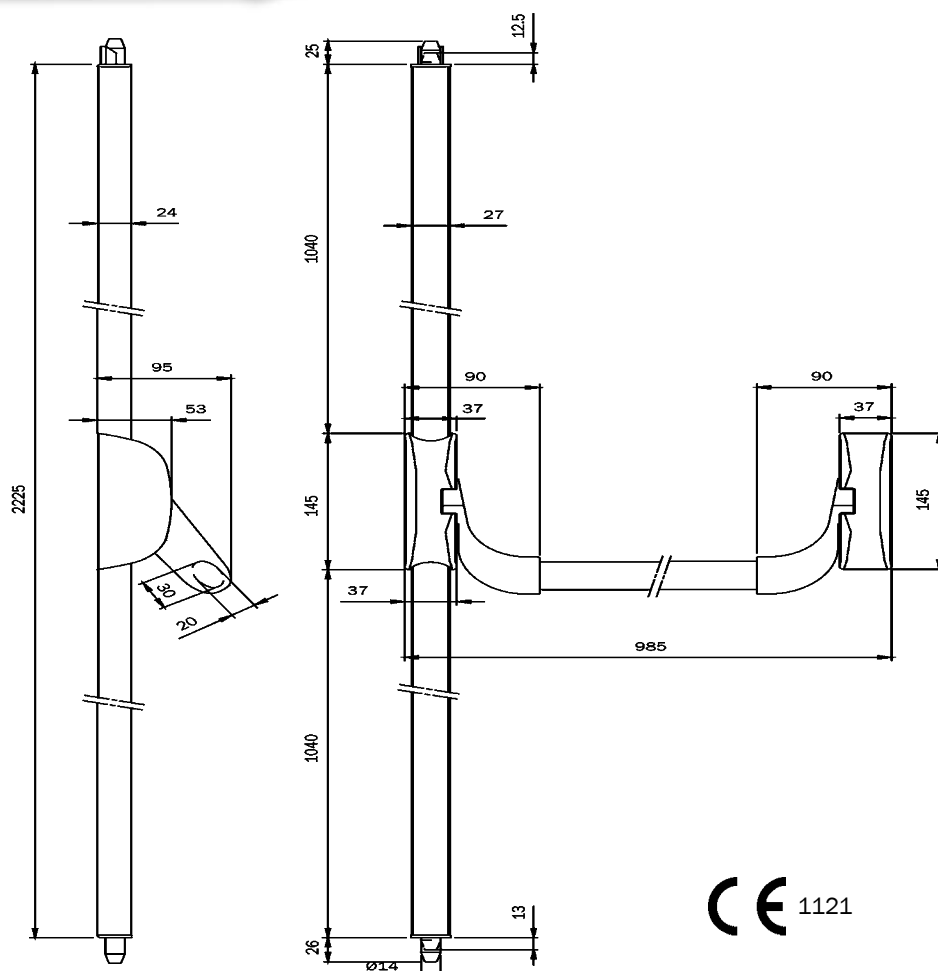



## PULLMAN RANGE

### EMERGENCY EXIT DEVICE

## Features

- Anti – thrust
- Pre-set for manual hold open device
- Easily reversible
- Simple to install
- Pre-set for micro switch
- Attractive aesthetic design
- Rounded edges for safer usage
- No exposed moving parts
- Compatible with any ISEO external access device ORDERED SEPARATELY

## Classification

### EN 1125:2008

3	7	6	B	1	4	2	2	B	A
---	---	---	---	---	---	---	---	---	---

### EN 179:2008

3	7	6	A	1	4	4	2	A	B
---	---	---	---	---	---	---	---	---	---



For use on  
fire doors



For use on  
escape doors







LATERAL FIXING



LATERAL TOP/MIDDLE/BOTTOM FIX



### Single Panic Latch Emergency Exit Device

Ref: **IS941-4113774**

Finish: **Grey**

- For use on single doors,  
or as active leaf on double rebated door sets
- EN-1125:2008

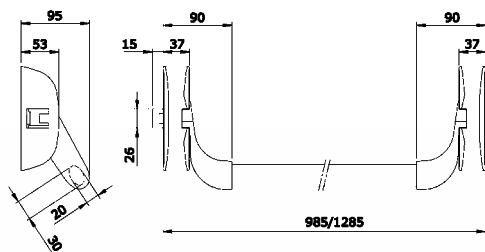

### 3 Point Lateral Side Latching Emergency Exit Device

Ref: **IS941-6113774**

Finish: **Grey**

**Dimensions as Diagram 1 except side latching  
top and bottom (see Diagram 2)**

- For use on single doors only
- Suitable for doors up to 2256mm in height  
for taller doors add rods and covers set  
IS941-00303 (up to 3400mm)
- EN-1125:2008

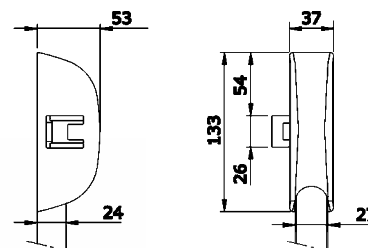

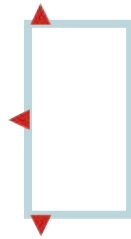

LATERAL AND VERTICAL FIXING



VERTICAL 2 POINT FIXING

### 3 Point Vertical Emergency Exit Device

Ref: **IS941-3113774**

Finish: **Grey**

- For use on single doors, or as passive leaf on double rebated door sets
- Suitable for doors up to 2245mm in height, for taller doors add rods and covers set, IS941-00303 (up to 3400mm)
- Can be modified to two point latch
- EN-1125:2008

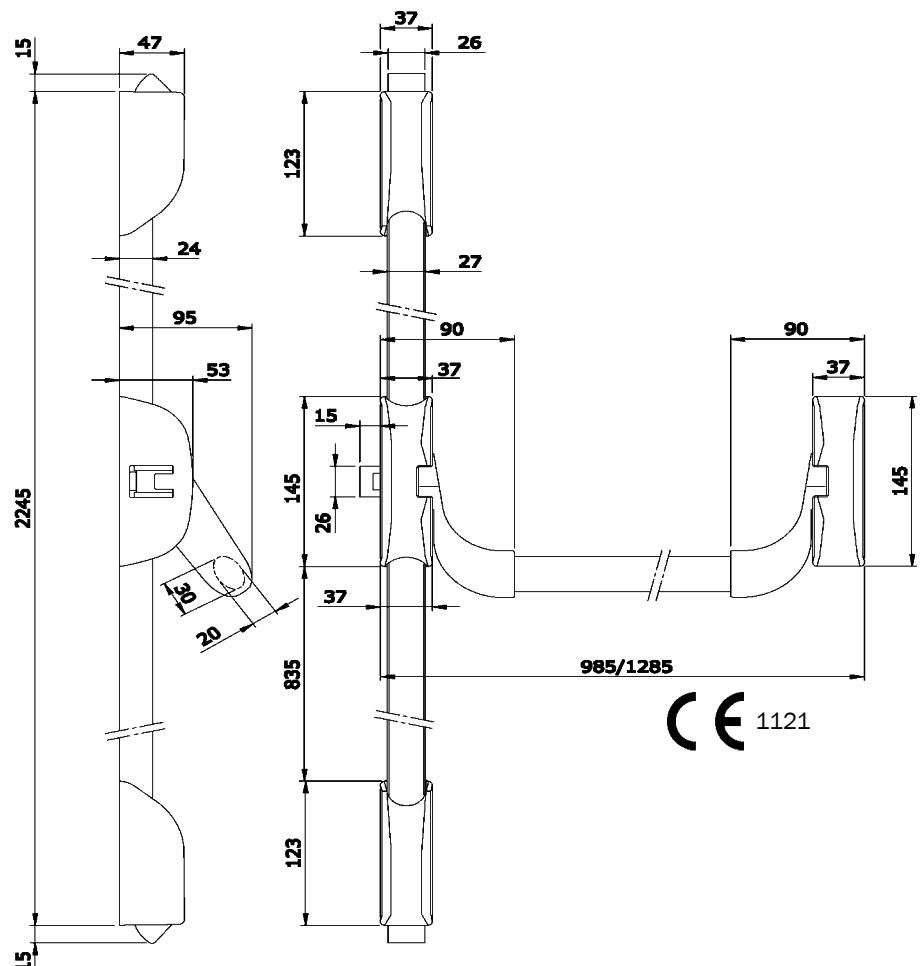



ISEO  
MADE IN ITALY  
AHH  
GERM

## TOUCH RANGE

### EMERGENCY EXIT DEVICE

## Features

- Anti – thrust
- Pre-set for manual hold open device
- Easily reversible
- Simple to install
- Pre-set for micro switch
- Attractive aesthetic design
- Rounded edges for safer usage
- No exposed moving parts.
- Fast and easy to install reducing labour time
- Compatible with any ISEO external access device ORDERED SEPARATELY

## Classification

### EN 1125:2008

3	7	6	B	1	4	2	2	B	A
---	---	---	---	---	---	---	---	---	---

### EN 179:2008

3	7	6	A	1	4	4	2	A	B
---	---	---	---	---	---	---	---	---	---



For use on  
fire doors



For use on  
escape doors







LATERAL FIXING



LATERAL TOP/MIDDLE/BOTTOM FIX



- For use on single doors, or as active leaf on double rebated door sets.
- Bar supplied at 1165mm width, can be shortened to 330mm
- EN-1125:2008

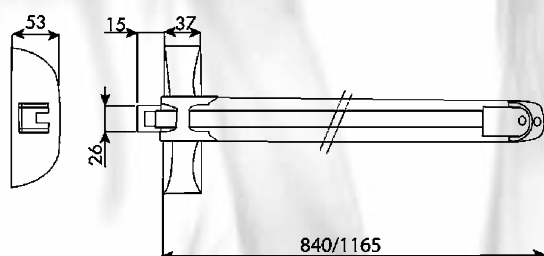

## Single Panic Latch

Ref: **IS942-413058T**

Finish: **Black/Red**



- For use on single doors, or as active leaf on double rebated door sets.
- Bar supplied at 1300mm width, can be shortened to 330mm
- EN-1125:2008

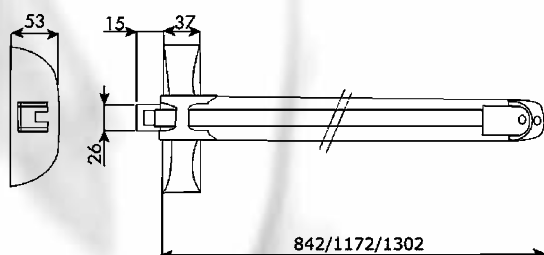

## 3 Point Lateral Side Latching Emergency Exit Device

Ref: **IS942-60845VT**

Finish: **Black/Green**

Dimensions as Diagram 1 except side latching top and bottom (see Diagram 2)



- For use on single doors only
- Bar supplied at 840mm width, can be shortened to 330mm
- Suitable for doors up to 2245mm in height, for taller doors add rods and covers set, IS941-00305 (up to 3400mm)
- EN-1125:2008

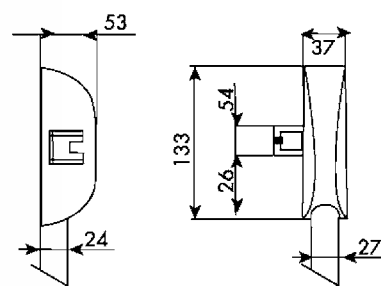

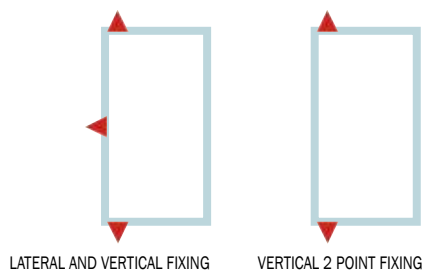

### 3 Point Vertical Emergency Exit Device

Ref: **IS942-30845VT**

Finish: **Black/Green**

- For use on single doors, or as passive leaf on double rebated door sets
- Bar supplied at 840mm width, can be shortened to 330mm
- Suitable for doors up to 2245mm in height, for taller doors add rods and covers set, IS941-00305 (up to 3400mm)
- EN-1125:2008

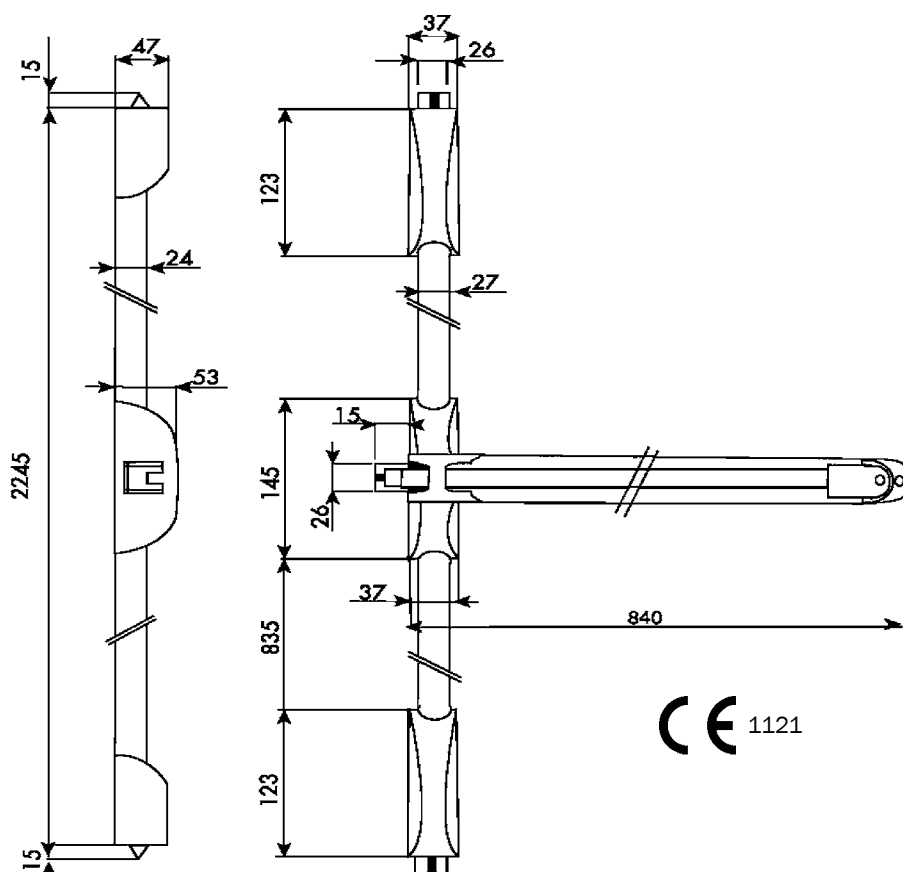



## INOX RANGE

STAINLESS STEEL P.V.D. FINISH

### Features

- Aisi Grade 304 Stainless Steel bar with P.V.D. coating
- 10 year finish guarantee
- Ideal for areas with high humidity
- Easily reversible
- Simple to install
- High usage - tested to 200,000 cycles
- Aesthetically pleasing design
- Rounded edges for safe usage
- Compatible with any ISEO external access device ORDERED SEPARATELY

### Classification

#### EN 1125:2008

3	7	6	B	1	4	2	2	B	A
---	---	---	---	---	---	---	---	---	---

#### EN 179:2008

3	7	6	A	1	4	4	2	A	B
---	---	---	---	---	---	---	---	---	---



For use on  
fire doors



For use on  
escape doors





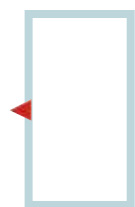

LATERAL FIXING



LATERAL TOP/MIDDLE/BOTTOM FIX



## Reversible Panic Latch Emergency Exit Device

Ref: **IS941-4113224**

Finish: **Stainless Steel  
PVD Finish**

- For use on single doors,  
or as active leaf on double rebated door sets
- Bar supplied is 1130mm in width, for  
wider doors add INOX bar IS945-932  
(up to 1300mm)
- EN-1125:2008

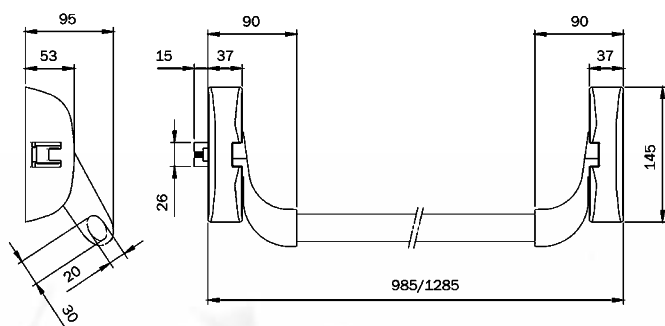

## 3 Point Lateral Side Latching MODULAR FORMAT

Finish: **Stainless Steel PVD**

Dimensions as Diagram except side  
latching top and bottom

- For use on single doors, or as passive  
leaf on double rebated door sets.
- Pre-set for manual hold open device
- Pre-set for micro switch
- No exposed moving parts
- EN-1125:2008

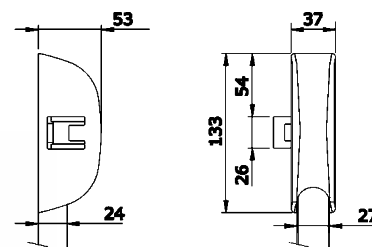

## Belvedere

Patch Fittings for Glass Doors  
Page 67-74

## MODULAR FORMAT

To order this version please use codes below

CODE	DESCRIPTION	QTY
IS941-4113224	INOX Panic Latch kit	x1
IS941-00202	Rods & covers suitable for 2400mm doors	x1
IS941-0203524	Lateral latches - pair	x1
IS941-00112	Side Keep	x2

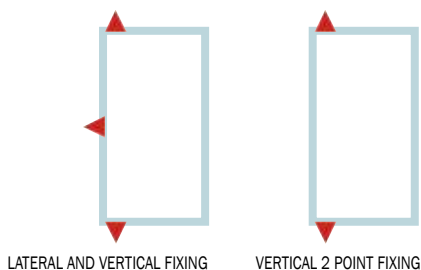

### 3 Point Vertical Emergency Exit Device MODULAR FORMAT

Finish: **Stainless Steel**  
**PVD Finish**

- For use on single doors, or as passive leaf on double rebated door sets
- Suitable for doors up to 2245mm in height, for taller doors add rods and covers set, IS941-00303 (up to 3400mm)
- Can be modified to two point latch
- Pre-set for manual hold open device
- Pre-set for micro switch
- No exposed moving parts
- EN-1125:2008

#### MODULAR FORMAT

To order this version please use codes below

CODE	DESCRIPTION	QTY
IS941-4113224	INOX Panic Latch kit	x1
IS941-00202	Rods & covers suitable for 2400mm doors	x1
IS941-0201524	Vertical latches - pair	x1
IS941-00112	Side Keep	x1
IS941-00227	Floor Keep	x1

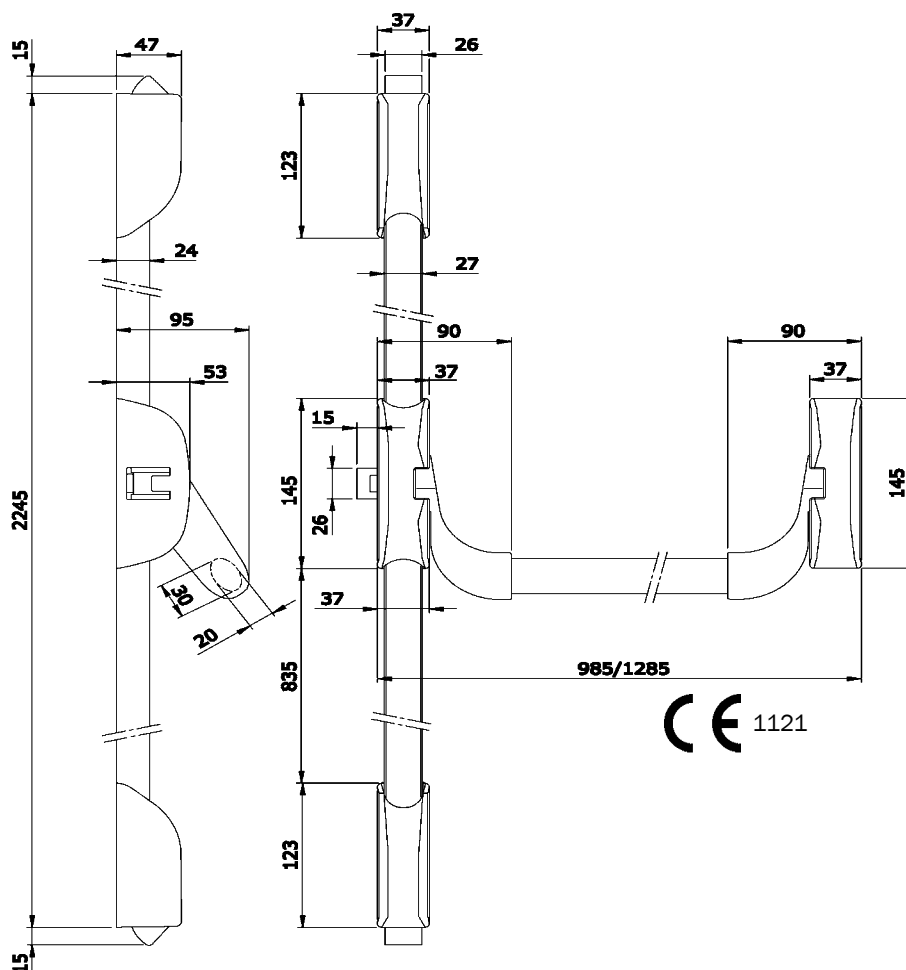



## TRIM ACCESS DEVICES

FOR PANIC HARDWARE

### Features

- All compatible with any ISEO Panic Exit Devices featured within this publication
- High durability tested
- Aesthetically designed





### Lever Handle With 5 Pin Single Cylinder

Ref: **IS940-11007** - GREY  
Ref: **IS940-11005** - BLACK  
Ref: **IS940-11002T** - INOX

- Can be used with any 40mm euro single cylinder
- Lever fitted with Anti-Vandalism feature

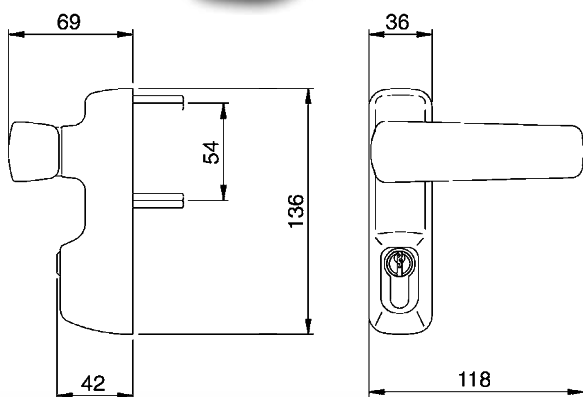

### Lever Handle Without Cylinder

Ref: **IS940-14007** - GREY  
Ref: **IS940-14005** - BLACK

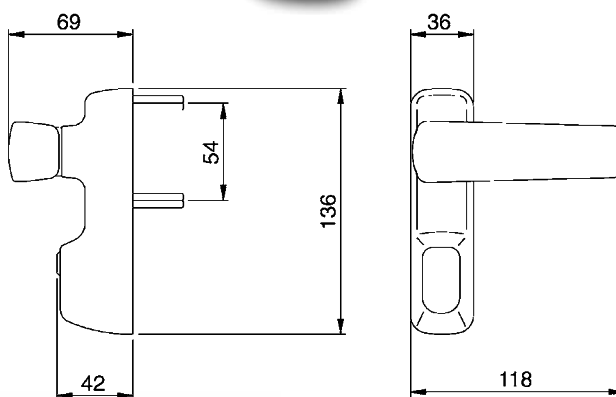

### Vertical Lever Handle With 5 Pin Cylinder

Ref: **IS940-12007** - GREY  
Ref: **IS940-12005** - BLACK  
Ref: **IS940-12002T** - INOX

- Can be used with any 40mm euro single cylinder

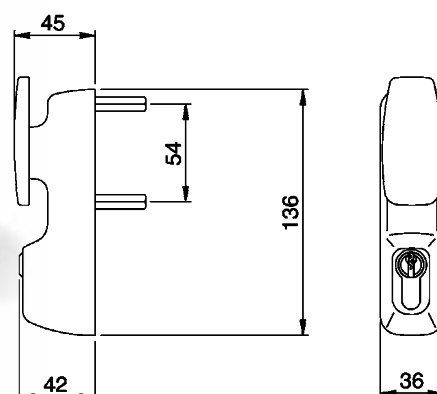

### Vertical Lever Handle Without Cylinder

Ref: **IS940-15007 - GREY**

Ref: **IS940-15005 - BLACK**

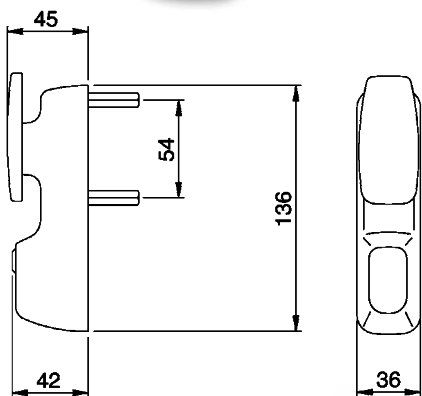

### Lever Handle With 5 Pin Cylinder & Micro Switch

Ref: **IS940-11017T - GREY**

Ref: **IS940-11015T - BLACK**

- Can be used with any 40mm euro single cylinder
- Lever fitted with Anti-Vandalism feature
- Lever fitted with Microswitch

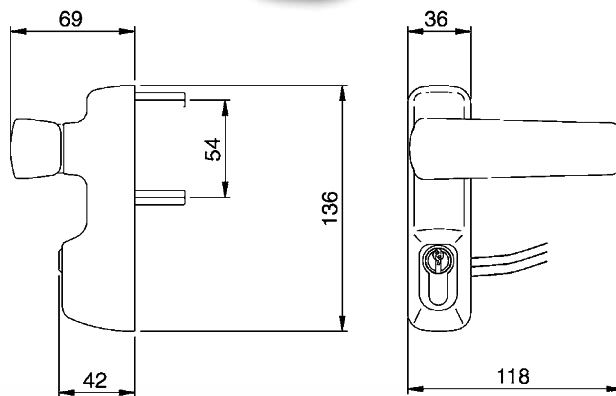

### FIXED Knob With 5 Pin Cylinder

Ref: **IS940-13007 - GREY**

Ref: **IS940-13005 - BLACK**

- Can be used with any 40mm euro single cylinder
- Fixed lever design
- Requires key after every action

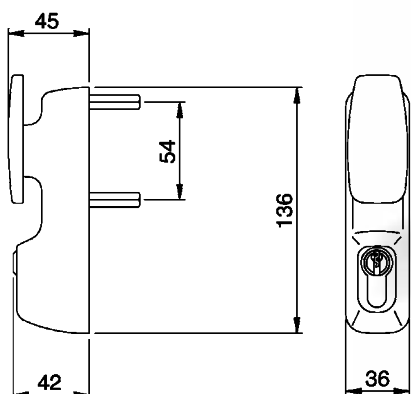



Escape routes represent a guarantee for people's safety in case of fire or emergency. Yet, they are always critical points for the security of the buildings and the goods they contain. If not adequately monitored, they become the ideal way for intruders to walk in and out. Push Sirena by ISEO offers the solution to these problems.

No need for complex and expensive alarm systems on your door. Push Sirena is installed as a traditional panic exit device but has an acoustic alarm: when it is activated, it immediately detects any unauthorized opening of the escape route door. Therefore, it represents the ideal solution for shops, small warehouses and all places where escape routes need constant monitoring.

Through a selector operated by a key half-cylinder the user can program the functions and choose the device status, namely: ON, OFF and BREAK (courtesy function allowing exit without triggering the alarm). If the bar is pressed and the alarm is ON, the powerful siren emits a strong acoustic signal (90dB). The device LEDs show the current status as well as the battery status.

To order Push Sirena use the following order codes:

**Sirena Attachment Grey : IS942-00093**

**Sirena Attachment Black : IS942-00095**

Please note that ISEO Touch Bar is ordered separately

## Device Status (Key operated)

- **OFF:**  
the bar can be pressed without triggering the alarm.
- **ON:**  
the alarm, both acoustic and visual, comes into operation when the bar is pressed.
- **Break or courtesy function:**  
a temporary status (5 sec.) within the ON status allowing exit without triggering the alarm.
- **Ongoing alarm:**  
when the alarm is ON and the bar is pressed, the device emits a strong acoustic signal and a red LED flashes.

## PUSH SIRENA

ALARMED PERMANENT SECURITY FOR PUBLIC SPACES

- Courtesy function allowing exit without alarm.
- Alarm reset by key only.
- Acoustic and LED signals showing the device and battery status.
- Powered by 2 AA alkaline batteries (over 2 years of life without alarms).
- 3-level battery charge indicator allowing scheduled replacement.
- Selector compatible with European half-cylinders (size 30+10 with 8-position DIN cam).





## PANIC HARDWARE ACCESSORIES

### Electric Strike

Ref: **IS568-0003 - GREY**  
**IS568-0000 - BLACK**

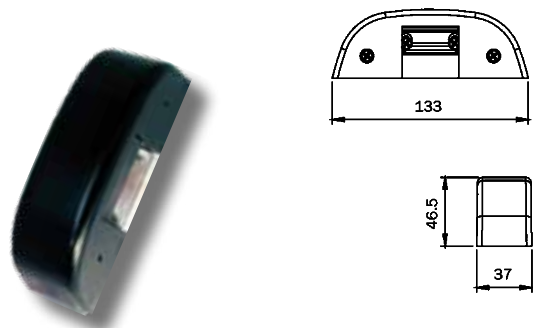

- Suitable for use with Pullman and Touch panic exit devices
- 12V - 15 Watt (AC)
- For INOX finish add cover plate IS568-0012
- Anti-thrust feature

### Pair Of Steel Vertical Latches

Ref: **IS941-0201704 - GREY**  
**IS941-0201504 - BLACK**

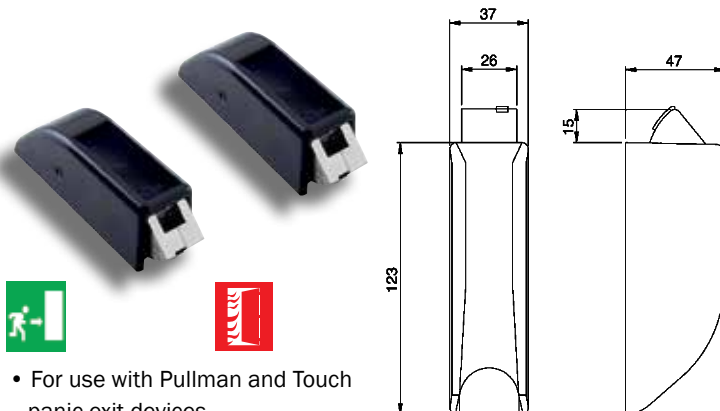

- For use with Pullman and Touch panic exit devices
- Self locking
- Steel latch suitable for fire doors
- Anti-thrust feature

### PVD Lateral Latch

Ref: **IS941-0203524 - INOX**

- For ISEO INOX Panic Exit Device
- Self Locking
- Suitable for fire doors
- Anti-thrust feature



### PVD Vertical Latch

Ref: **IS941-0201524 - INOX**

- For ISEO INOX Panic Exit Device
- Self Locking
- Suitable for fire doors
- Anti-thrust feature



### PVD Vertical/ Lateral Latch

Ref: **IS941-0204524 - INOX**

- For ISEO INOX Panic Exit Device
- Self Locking
- Suitable for fire doors
- Anti-thrust feature

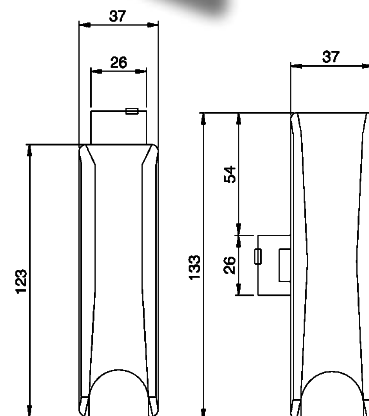
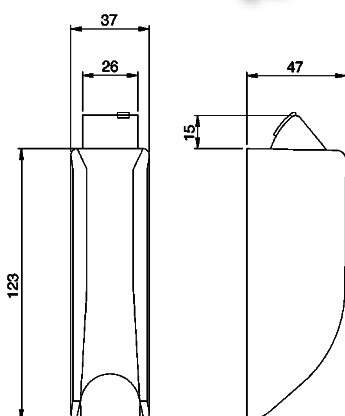
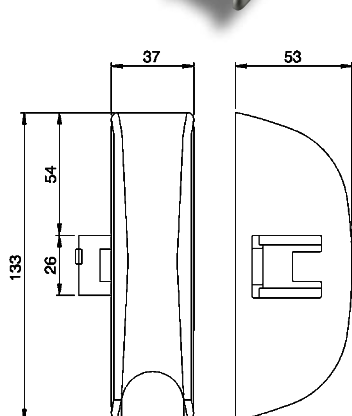



## PANIC HARDWARE ACCESSORIES

### Pair of Lateral Latches

Ref: **IS941-0203704 - GREY**  
**IS941-0203504 - BLACK**

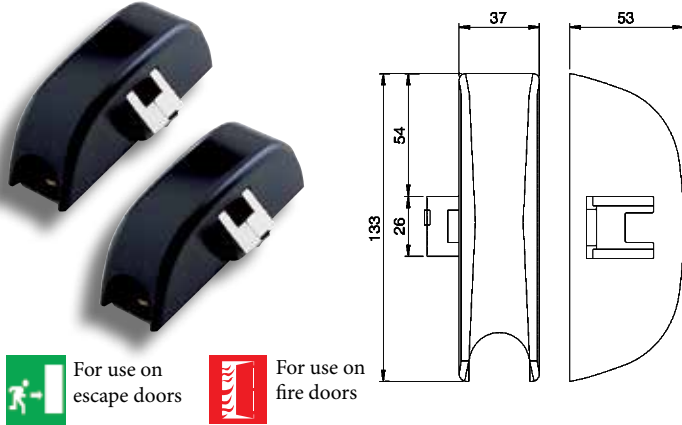

For use on  
escape doors



For use on  
fire doors

- Suitable for use with Pullman and Touch panic exit devices
- Self locking
- Steel latch suitable for fire doors
- Anti-thrust feature

### Pair of Vertical & Lateral Mix Latches

Ref: **IS941-0204704 - GREY**  
**IS941-0204504 - BLACK**

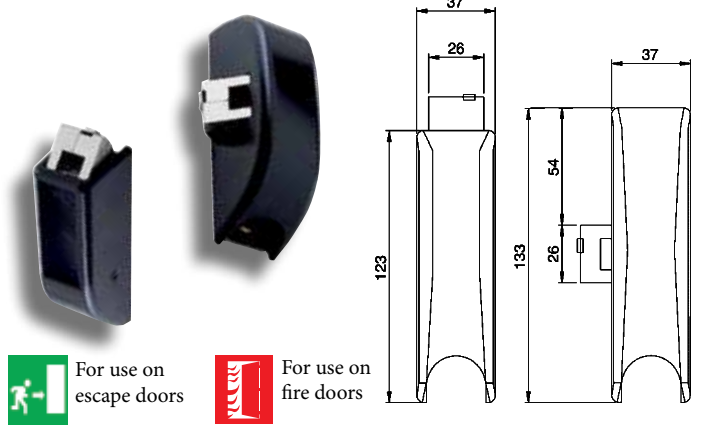

For use on  
escape doors



For use on  
fire doors

- Suitable for use with Pullman & Touch panic exit devices
- Self locking
- Steel latch suitable for fire doors
- Anti-thrust feature

### Replacement Central Mechanisms

Ref: **IS941-4000704 - GREY**



For use on  
escape doors



For use on  
fire doors



- Use ONLY with Pullman panic exit devices
- Use with all variations of latching points
- Steel latch suitable for fire doors
- NOT Suitable for use with UK panic hardware rods & bolts
- Anti-thrust feature

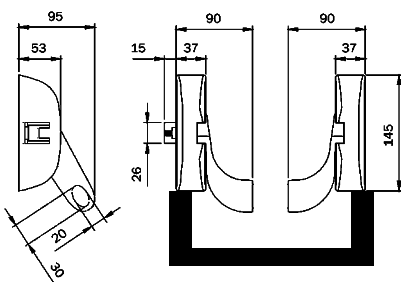

### INOX Replacement Central Mechanisms

Ref: **IS941-4000524 - INOX**



For use on  
escape doors



For use on  
fire doors



- Use with INOX panic exit devices
- Use with all variations of latching points
- Steel latch suitable for fire doors
- NOT Suitable for use with UK panic hardware rods & bolts
- Anti-thrust feature

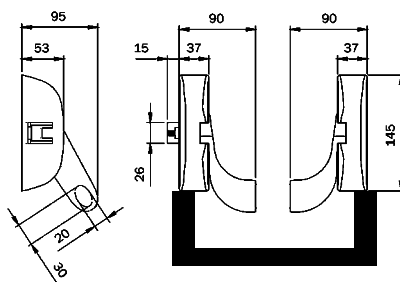

### 1300mm Long Touch Bar Unit

Ref: **IS942-413058T Finish: Black/Red**



For use on  
escape doors



For use on  
fire doors



- Single panic latch
- Can be either vertical, lateral or vertical lateral mix by adding relevant component parts of rods, covers & latches (accessories section)
- For use on doors up to 1300mm in width
- Anti-thrust feature

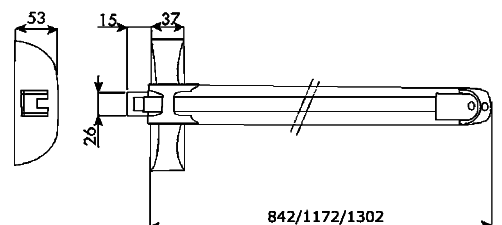

## PANIC HARDWARE ACCESSORIES

### Micro-switch

Ref: **IS941-00060**



- Mechanisms for UK, Pullman and INOX, are pre-set for this microswitch
- Used to detect door opening
- Can be used with security system

### Micro-switch For Touch Devices

Ref: **IS942-00060**



- Mechanisms for Touch panic are bar pre-set for this microswitch
- Used to detect door opening
- Can be used with security system

### Thermo-expanding Gasket Kit

Ref: **IS940-00030**

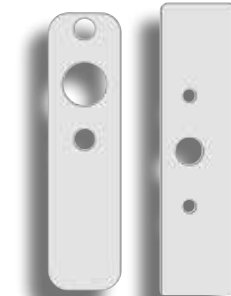

- Suitable for use with UK, Pullman, Touch & INOX devices
- For use with smoke doors

### Side Striker

Ref:

**IS941-00117 - GREY**  
**IS941-00110 - BLACK**  
**IS941-00112 - INOX**

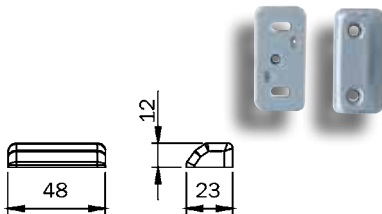

- Suitable for use with UK, Pullman, Touch & INOX panic exit devices
- For lateral latch, single or double

### Lateral Striker For Double Doors

Ref:

**IS941-00107 - GREY**  
**IS941-00100 - BLACK**  
**IS941-00102 - INOX**

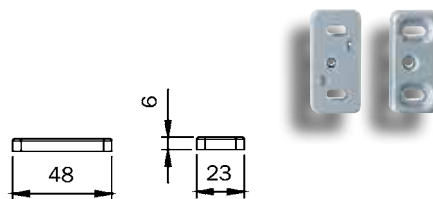

- Suitable for use with UK, Pullman, Touch & INOX panic exit devices

### Lateral Keep For PVCu Doors

Ref:

**IS941-00157 - GREY**  
**IS941-00150 - BLACK**  
**IS941-00152 - INOX**

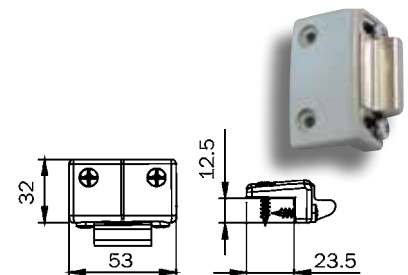

- IUse in bracket of UK, Pullman & INOX panic exit devices
- For use with profiles with an overlap of 14 to 24mm

### UK Range 3400mm Rods & Covers

Ref:

**IS943-00307 - GREY**



### 2400mm Rods & Covers

Ref:

**IS941-00207 - GREY**  
**IS941-00205 - BLACK**  
**IS941-00202 - INOX**



### 3400mm Rods & Covers

Ref:

**IS941-00307 - GREY**  
**IS941-00305 - BLACK**  
**IS941-00302 - INOX**



## PANIC HARDWARE ACCESSORIES

### Hold Open Device

Ref: **IS941-00070**



- Use in bracket of UK, Pullman & INOX panic exit devices
- Mechanically holds panic exit device in 'open' mode

### Fixing Plate For Central Mechanism

Ref: **IS941-00040**



- Suitable for use with UK, Pullman, Touch & INOX panic exit devices
- For use with steel doors

### Fixing Plate For Top & Bottom Latches or Bolts

Ref: **IS941-00050**



- Use with UK, Pullman, Touch & INOX panic exit devices

### Adjustable Keep

Ref:

**IS941-00137 - GREY**  
**IS941-00130 - BLACK**  
**IS941-00132 - INOX**

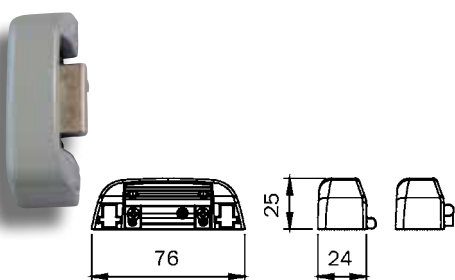

- Suitable for use in bracket of UK, Pullman & INOX panic exit devices
- Use with profiles with an overlap up to 11mm

### Floor Keep

Ref:

**IS941-00127 - GREY**  
**IS941-00120 - BLACK**  
**IS941-00227 - INOX**

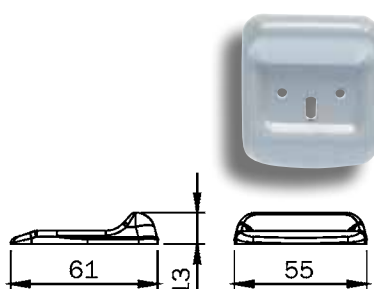

- Suitable for use with Pullman & Touch panic exit devices

### IDEA UK Top Keep (for PVCu doors)

Ref:

**IS943-00167 - GREY**

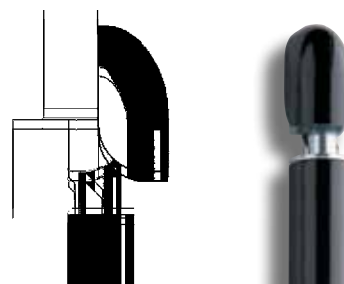

- Suitable for UK panic exit devices only

### Blanking Plates for Latch Piece

Ref:

**IS941-00705 - BLACK**  
**IS941-00707 - GREY**



- Suitable for use with all Ranges

### Blanking Plates for Rods

Ref:

**IS-KW50395C**



- Suitable for use with Touch Range only

### Long Central Bar

**IS945-932 - INOX - 1330mm**



**IS945-927 - GREY - 1130mm**



**IS945-928 - RED - 1130mm**



**IS945-929 - GREEN - 1300mm**



- Suitable for use with:  
UK, Pullman & INOX panic exit devices

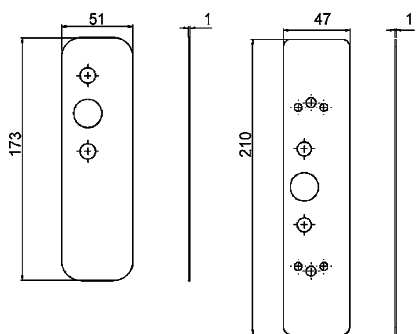

## RETROFIT PLATES

FOR THE REPLACEMENT OF PANIC EXIT DEVICES NOT MANUFACTURED BY ISEO

### Retrofit Plates

Ref: **IS941 00655**

- Kit made of:  
a plate for external control and two plates for devices

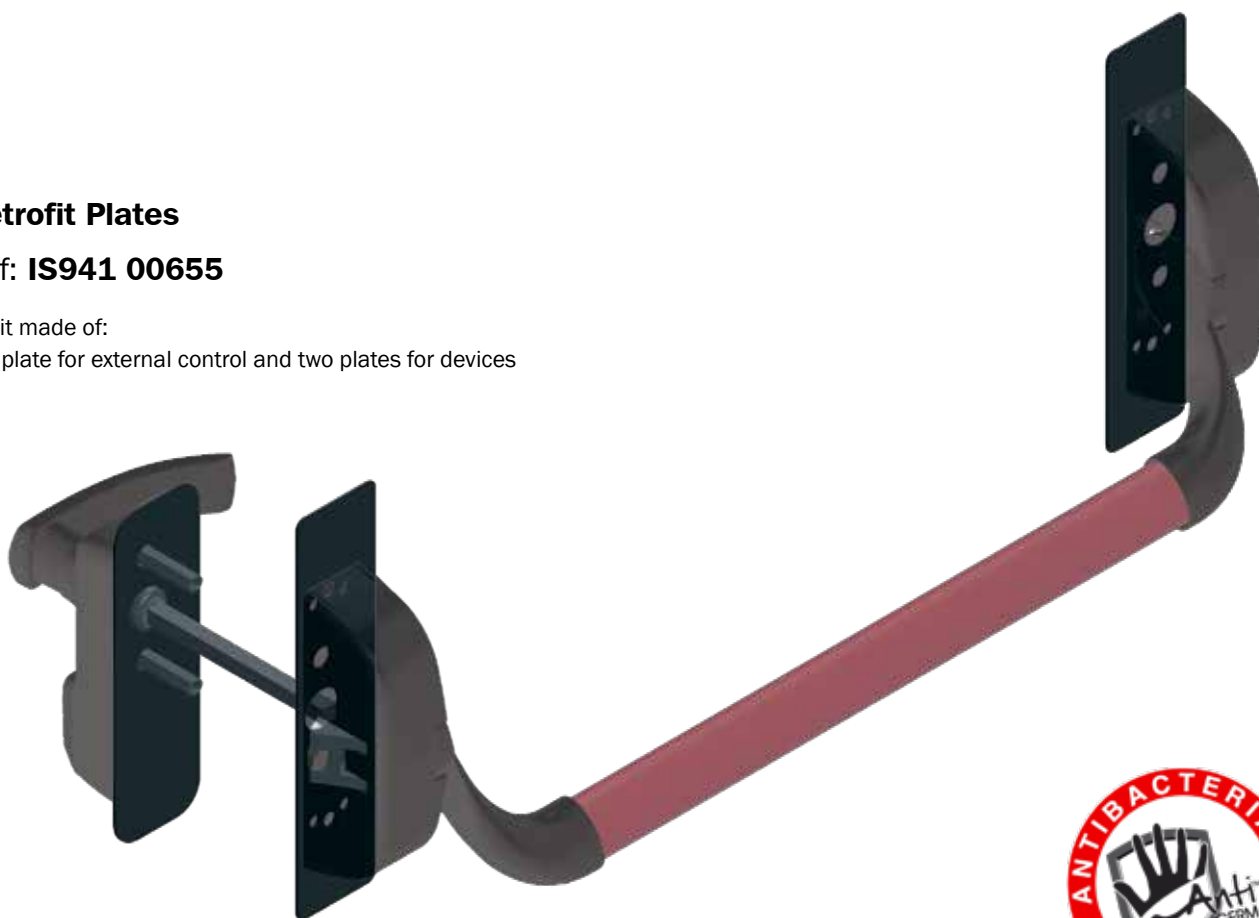



## **Belvedere**

ASSEMBLY KIT FOR GLASS DOORS

### **Fittings for:**

- ISEO Bolt
- Pullman and Touch
- Panic Exit Devices



## Belvedere

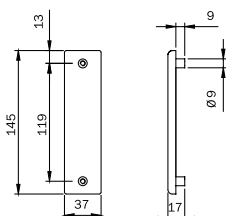

Assembly kit for glass doors thickness max 12 mm. **FOR CENTRAL LOCK ASSEMBLY TYPE - PULLMAN | BOLT WITHOUT EXTERNAL CONTROL.** Reversible. PVD finish cover plates, gaskets, fixing screws. Instructions.

IS941-00506

External right-hand

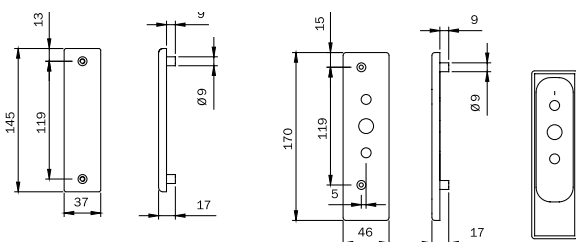
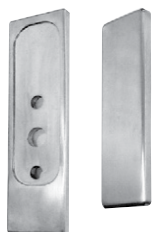

Assembly kit for glass thickness max 12 mm. **FOR CENTRAL LOCK ASSEMBLY TYPE - PULLMAN | BOLT CAN BE USED WITH EXTERNAL CONTROL FOR DOOR OPENING.**

PVD finish cover plates, gaskets, fixing screws. Instructions.

**Can be used in conjunction with:**

**EXTERNAL RIGHT-HAND**

IS941-00516

**EXTERNAL LEFT-HAND**

IS941-00526

External left-hand

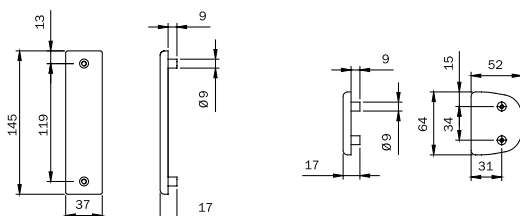

Assembly kit for glass thickness max 12 mm. **FOR CENTRAL LOCK ASSEMBLY TYPE TOUCH BAR**

**WITHOUT EXTERNAL CONTROL. REVERSIBLE.** PVD finish cover plates, gaskets, fixing screws. Instructions.

IS941-00536

## Belvedere

External right-hand

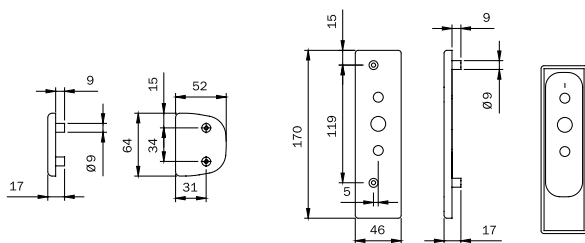

Assembly kit for glass thickness max 12 mm. **FOR CENTRAL LOCK ASSEMBLY TYPE TOUCH BAR**  
**CAN BE USED WITH EXTERNAL CONTROL FOR DOOR OPENING.** PVD finish cover plates,  
gaskets, fixing screws. Instructions.

EXTERNAL RIGHT-HAND

IS941-00546

EXTERNAL LEFT-HAND

IS941-00556

External left-hand

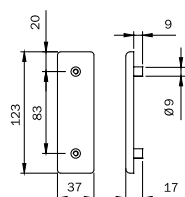

Assembly kit for glass thickness max 12 mm. **FOR PAIR OF VERTICAL LATCHES PULLMAN|TOUCH**  
PVD finish cover plates, gaskets, fixing screws. Instructions.

**Can be used in conjunction with:**

Pair of vertical latches 94102015\*

IS941-00566

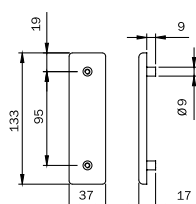

Assembly kit for glass thickness max 12 mm. **FOR PAIR OF LATERAL LATCHES PULLMAN|TOUCH**  
PVD finish cover plates, gaskets, fixing screws. Instructions.

**Can be used in conjunction with:**

Pair of lateral latches 94102035\*

IS941-00576

## Belvedere

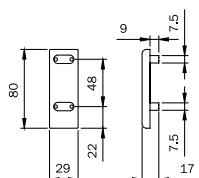

Assembly kit for glass thickness max 12 mm. **FOR PAIR OF VERTICAL RODS "Bolt"**.  
PVD finish cover plates, gaskets, fixing screws. Instructions.

**IS941-00586**

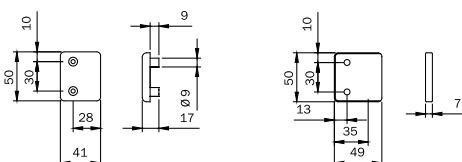

Assembly kit for glass thickness max 12 mm. **FOR LATERAL KEEP AND TOP VERTICAL KEEP**.  
PVD finish cover plates, gaskets, fixing screws. Instructions.

**IS941-00596**

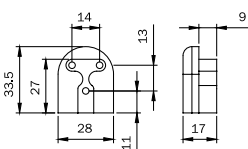

Assembly kit for glass thickness max 12 mm. **FOR ADJUSTABLE TOP KEEP**  
**FOR PANIC EXIT DEVICES "Bolt"**. PVD finish cover plates, gaskets, fixing screws. Instructions.

**IS941-00606**

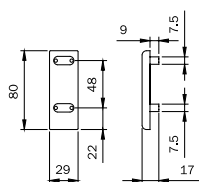

Assembly kit for glass thickness max 12 mm. **FOR RODS COVER EXTENSION**.  
PVD finish cover plates, gaskets, fixing screws. Templates. Instructions.

**Can be used in conjunction with:**

**All rod and cover kits for door with maximum height of 3400 mm**

**IS941-00636**

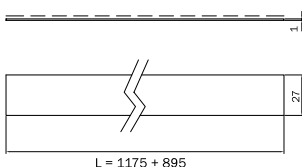

Kit of rod covering profiles  
for assembly on glass doors

**IS941-00616**

## ISEO Pullman Application scheme for single leaf glass doors

	WITH LATCHES												WITH BOLT				
	▲	▲	▲	▲	▲	▲	▲	▲	▲	▲	▲	▲	▲	▲	▲	▲	▲
IS941-00566			●	●	●	●	●										
IS941-00576								●	●	●	●						
IS941-00586													●	●	●	●	●
IS941-00596		●		●		●	●		●	●		●					●
IS941-00606														●		●	●
IS941-00616			●	●	●	●	●	●	●	●	●	●	●	●	●	●	●

● = Necessary items ( ● ● = 2 pcs, ● ● ● = 3 pcs)

▲ = Choose 1 kit according to the external control and the "hand" of door

■ = Choose 2 kits according to the external control and the "hand" of door

## ISEO Pullman Application scheme for double glass doors

	WITH LATCHES						WITH BOLT	
 IS941-00506  IS941-00516  IS941-00526	■	■	■	■	■	■	■	■
 IS941-00566  IS941-00576	●	●	●	●	●	●		
 IS941-00586			●	●	●	●		
 IS941-00596	●	● ●	● ● ●	● ● ●	● ●	● ● ●	●	●
 IS941-00606								●
 IS941-00616	●	●	● ●	● ●	● ●	● ●	●	●

● = Necessary items ( ● ● = 2 pcs, ● ● ● = 3 pcs)

▲ = Choose 1 kit according to the external control and the "hand" of door

■ = Choose 2 kits according to the external control and the "hand" of door



## ISEO Touch Application scheme for single leaf glass doors









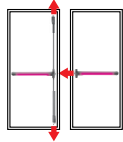
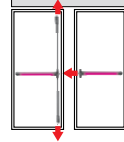
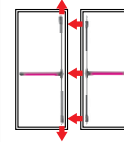
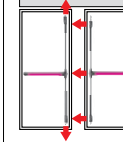
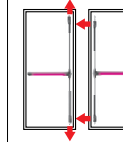
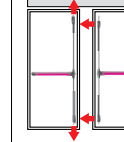
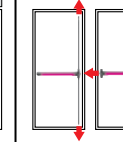
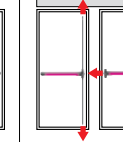

	WITH LATCHES											WITH BOLT				
IS941-00536																
IS941-00546	▲	▲	▲	▲	▲	▲	▲	▲	▲	▲	▲	▲	▲	▲	▲	▲
IS941-00556																
IS941-00566			●	●	●	●	●									
IS941-00576								●	●	●	●					
IS941-00586												●	●	●	●	●
IS941-00596		●		●		●	●		●	●	●					●
IS941-00606													●		●	●
IS941-00616			●	●	●	●	●	●	●	●	●	●	●	●	●	●

● = Necessary items ( ● ● = 2 pcs, ● ● ● = 3 pcs)

▲ = Choose 1 kit according to the external control and the "hand" of door

■ = Choose 2 kits according to the external control and the "hand" of door

## ISEO Touch Application scheme for double glass doors

	WITH LATCHES						WITH BOLT	
								
 IS941-00536  IS941-00546  IS941-00556								
 IS941-00566	●	●	●	●	●	●		
 IS941-00576			●	●	●	●		
 IS941-00586							●	●
 IS941-00596	●	● ●	● ● ●	● ● ●	● ●	● ● ●	●	●
 IS941-00606								●
 IS941-00616	●	●	● ●	● ●	● ●	● ●	●	●

- = Necessary items ( ● ● = 2 pcs, ● ● ● = 3 pcs)  
 ▲ = Choose 1 kit according to the external control and the "hand" of door  
 ■ = Choose 2 kits according to the external control and the "hand" of door

# ISEO® Zero1

## ELECTRONIC SOLUTIONS

A new range of electronic products by ISEO Group which totally changes the way to manage security and access control systems

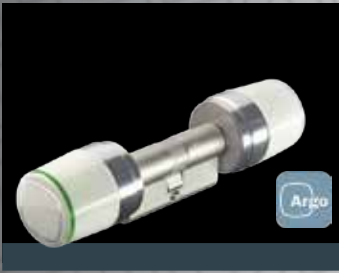

**Libra** SMART  
Electronic Knob Cylinder



**Aries** SMART  
Electronic Trim Set



**F9000** Electromechanical  
Profile cylinder



**Stylos** SMART  
Credential Reader



**Thesis 2.0**  
High Security Solenoid Bolt



**Push Sirena** Panic Exit  
Device with Acoustic Alarm



**X1R** SMART  
Electromechanical Lock for  
Armoured Doors



**Multiblindo**  
**Motion** EXIT  
Electronic Multipoint Lock



**Trim Tronic**  
Electronic Access Device

presented by



**M. Marcus Limited**

Unit 7, Narrowboat Way, Dudley,  
West Midlands, DY2 0XQ, England

**Tel: 01384 457900**  
**Fax: 01384 253687**

Web: [www.m-marcus.com](http://www.m-marcus.com)  
Email: [iseosales@m-marcus.com](mailto:iseosales@m-marcus.com)

## TERMS & CONDITIONS

1. This price list cancels all previous price lists.
2. Prices charged will be those ruling at date of despatch of goods.
3. Carriage paid order minimum £100.00 at nett invoice value.
4. For orders under £100.00 nett invoice value a carriage charge of £4.50 will apply.
5. In the case of Northern Ireland, the Republic of Ireland, Channel Islands, the Scottish Highlands and Islands, the Isle of Man, for orders under £200.00 nett invoice value there is a carriage charge of £20.00
6. For reasons of security products cannot be delivered direct to site, all items will only be delivered to the business or trade premises of our account holders.
7. Payment Terms: 30 days nett.
8. Stock orders are dispatched in 1-2 working days, master keyed or keyed alike orders are normally dispatched in 3 working days. However, to guarantee receipt by 12.00 noon next working day, orders must be placed before 12.00 and are subject to a £20.00 charge.
9. Shortages must be notified to us within 3 days of receipt of a consignment otherwise no claims can be entertained.
10. Returns: No returns will be accepted without prior written agreement. "Unauthorised returns will be refused and those agreed may be subject to a minimum restocking charge of 40%.

It is the responsibility of distributors to ensure that the correct product code and description is quoted/used when placing orders by phone/fax with our sales office. Failure to do so may result in the implementation of the full restocking charge for incorrectly ordered items.

(Returns procedure applies, please contact the M. Marcus Call Centre for information).

11. Any order or balance cancellation will ONLY be accepted by fax or email.
12. Any specially ordered non-stock lines cannot be cancelled unless agreed otherwise in writing by us.
13. All goods invoiced remain the property of M. Marcus Ltd until paid for in full.
14. Due to a continuous programme of development, M. Marcus Ltd., reserves the right to make alterations without notice.
15. For technical reasons connected with colour reproduction the colours shown may vary slightly from those of the product.
16. All dimensions provided are for guidance only.
17. Use of our images on the website: The Advertising Standards Authority have issued a ruling update from 1st March 2011 regarding website marketing and advertising – please refer to [www.asa.org.uk](http://www.asa.org.uk) for "The CAP Code" to ensure you are not in breach of any regulations.

presented by



m.marcus  
est. 1940

M. Marcus Limited  
Unit 7, Narrowboat Way, Dudley,  
West Midlands, DY2 0XQ,  
England

**Tel: 01384 457900**  
**Fax: 01384 253687**

Web: [www.m-marcus.com](http://www.m-marcus.com)